

Data sheet

Support roller NATV 30 PP X (cylindrical, with axial guidance, full needle, seal)

Designation	NATV 30 PP X
Type	cylindrical
D [mm]	62
d [mm]	30
d1 [mm max.]	51
B1 [mm]	29
B [mm]	28
r [mm]	1
Dynamic load Crw[N]	30500
Static load C0rw[N]	63000
Speed limit [min-1]	1700
Speed limit [min-1]	2200

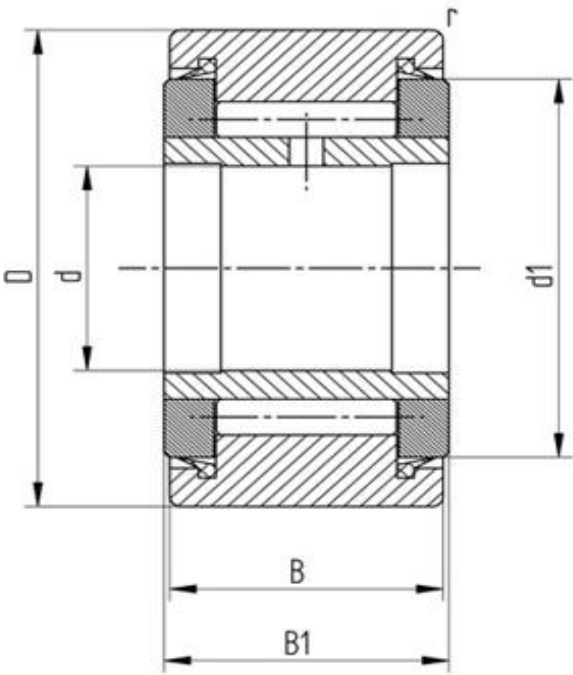

Every specification has been edited and verified carefully. STI Bearings GmbH assumes no liability for potential errors or incompleteness. Technical modifications are subject of changes.

© 2020 by STI Bearings GmbH
Reproduction, even excerpts, only with our approval.